



Hex Nuts

A

Assortments

- Machine Screw Sized Nuts & Washers B-2
- Miscellaneous Nuts
 - Machine Screw Nuts, Wing Nuts & Cap Nuts Assortmen B-2

F

Fasteners

- Cap Nuts B-15
- Coupling Nuts B-14
- Flange Nuts
 - Stover B-6
- Heavy Hex Nuts B-14
- Hex Jam Nuts B-13
- Hex Nuts
 - Finished B-9
 - Grade 5 B-9
 - Grade 8, Finished B-7
 - Hi-Alloy B-3
- High Nuts
 - Grade 8 B-15
- Kep Nuts B-12
- Lock Nuts, Hi-Alloy
 - Coarse B-4
 - Fine B-5
- Machine Screw Nuts B-12
- Nyloc Jam Nuts B-13
- Nylon Locknuts
 - Grade 5, Zinc Plated B-11
 - Grade 8, Plain B-10
 - Grade 8, Zinc Yellow B-10
- "Tee" Nuts B-16
- Torque Locknuts
 - Grade C B-8
- Whiz Lock Nuts B-12
- Wing Nut - Nyloc B-15
- Wing Nuts B-16

N

Nuts, Flange

- Stover B-6

Nuts, Hex B-3

- Finished
 - Grade 5 B-9
 - Grade 8 B-7
 - Zinc Plated B-9

- Grade 8
 - High Nuts B-15
 - Heavy B-14
 - High-Alloy B-3
- Nuts, Lock
 - Grade C B-8
 - High-Alloy N.C. B-4
 - L9 Stover® B-4
 - PFC9 B-4
 - High-Alloy N.F. B-5
 - L9 Stover® B-5
 - PFC9 B-5
 - Nylon, Grade 5
 - Zinc Plated B-11
 - Nylon, Grade 8
 - Plain B-10
 - Zinc Yellow B-10
- Nuts, Miscellaneous
 - Cap B-15
 - Coupling B-14
 - Jam
 - Hex B-13
 - Nyloc B-13
 - Kep B-12
 - Machine Screw B-12
 - Tee B-16
 - Whiz Lock B-12
 - Wing B-16
 - Wing Nut
 - Nyloc B-15

H E X N U T S



IBS, INCORPORATED

Assortments Z02

Machine Screw Nuts, Wing Nuts & Cap Nuts Assortment

IBS No. 126R • 18 Items - 1225 Pieces



IBS

INCORPORATED

Machine Screw Nuts,
Wing Nuts & Cap Nuts

Assortment No. 126R

8-32 Cap Nut 5076 	4-40 Machine Screw Nut 5032 	10-32 Machine Screw Nut 5036 	8-32 Wing Nut 5086 	1/4-20 Wing Nut 5089 
10-24 Cap Nut 5077 	6-32 Machine Screw Nut 5033 	12-24 Machine Screw Nut 5037 	10-24 Wing Nut 5087 	5/16-18 Wing Nut 5090 
1/4-20 Cap Nut 5079 	8-32 Machine Screw Nut 5034 	1/4-20 Machine Screw Nut 5038 	10-32 Wing Nut 5088 	3/8-16 Wing Nut 5091 
5/16-18 Cap Nut 5080 	10-24 Machine Screw Nut 5035 	5/16-18 Machine Screw Nut 5039 		

INDUSTRIAL BOLT & SUPPLY, INC. 1-800-678-1906

H
E
X

N
U
T
S

Machine Screw Sized Nuts & Washers

IBS No. 392R • 20 Items • 2,600 Pieces



IBS

INCORPORATED

Machine Screw Size
Nuts & Washers

Assortment No. 392R

#4 LW 7100 	#6 LW 7101 	#8 LW 7102 	#10 LW 7103 	#12 LW 7104 	1/4" LW 7105 
#4 SAE FW 7044 	#6 SAE FW 7045 	#8 SAE FW 7046 	#10 SAE FW 7047 	#12 SAE FW 7048 	1/4" SAE FW 7049 
4-40 MS Hex Nut 5032 	6-32 MS Hex Nut 5033 	8-32 MS Hex Nut 5034 	10-24 MS Hex Nut 5035 	10-32 MS Hex Nut 5036 	1/4-20 MS Hex Nut 5038 
12-24 MS Hex Nut 5037 	6-32 Nyloc Nut 5001 	8-32 Nyloc Nut 5002 	10-24 Nyloc Nut 5003 	10-32 Nyloc Nut 6099 	1/4-20 Nyloc Nut 5004 

IBS No. DL-24 IBS, INCORPORATED 1-800-678-1906





High-Alloy Hex Nuts

National Coarse & National Fine

- Cadmium-plated and dichromate-coated to improve lubrication for controlled tightening.
- 20% stronger than SAE Grade 8!
- Use of special alloys and heat treatments reduces the danger of split nuts and stripping of nuts.

HIGH ALLOY HEX NUTS - NC

IBS No.	Tap Size	W.A.F.	Thickness	Qty
NT5202	1/4-20	7/16	1/4	100
NT5204	5/16-18	1/2	19/64	50
NT5206	3/8-16	9/16	3/8	50
NT5208	7/16-14	11/16	7/16	25
NT5212	1/2-13	3/4	1/2	25
NT5214	9/16-12	7/8	9/16	25
NT5216	5/8-11	15/16	41/64	25
NT5218	3/4-10	1-1/8	3/4	20
NT5220	7/8-9	1-5/16	7/8	15
NT5222	1-8	1-1/2	1	10
NT5226	1-1/8-7	1-11/16	1-5/32	EA
NT5228	1-1/4-7	1-7/8	1-17/64	EA
NT5232	1-1/2-6	2-1/4	1-1/2	EA
W.A.F. = With Across Flats				

Top View

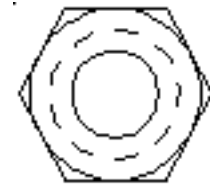

Nine circumferential dashes identify L9 Heat Treated Hex Nut.

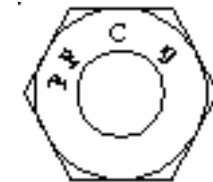

Side View



HIGH ALLOY HEX NUTS - NF

IBS No.	Tap Size	W.A.F.	Thickness	Qty
NT5252	1/4-28	7/16	1/4	100
NT5254	5/16-24	1/2	19/64	100
NT5256	3/8-24	9/16	3/8	50
NT5258	7/16-20	11/16	7/16	50
NT5262	1/2-20	3/4	1/2	25
NT5264	9/16-18	7/8	9/16	25
NT5266	5/8-18	15/16	41/64	25
NT5268	3/4-16	1-1/8	3/4	20
NT5270	7/8-14	1-5/16	7/8	15
NT5272	1-14	1-1/2	1	10
NT5276	1-1/8-12	1-11/16	1-5/32	EA
NT5278	1-1/4-12	1-7/8	1-17/64	EA
NT5282	1-1/2-12	2-1/4	1-1/2	EA
W.A.F. = With Across Flats				

**H
E
X

N
U
T
S**



IBS, INCORPORATED

High-Alloy Lock Nuts B03

High-Alloy Lock Nuts National Coarse

- Cadmium plated and dichromate coated
-ensures uniform tightening
- Inhibits loosening caused by vibration
- Reduced danger of split or stripped nuts

H
E
X

N
U
T
S

**Top
View**

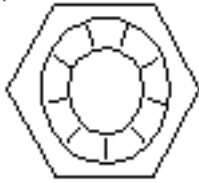

*Nine dashes identify
Heat Treated L9 Stover®
locknuts.
Features registered
stover design.*

**Side
View**



*Features unique
trilock design*

**Top
View**



**Bottom
View**

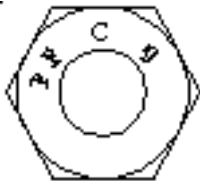

**Side
View**



HIGH ALLOY L9 STOVER LOCK NUT NC

IBS No.	Tap Size	W.A.F.	Thickness	Qty
NT9403	1/4-20	7/16	1/4	100
NT9405	5/16-18	1/2	19/64	50
NT9407	3/8-16	9/16	3/8	50
NT9409	7/16-14	11/16	7/16	25
NT9413	1/2-13	3/4	1/2	25
NT9415	9/16-12	7/8	9/16	25
NT9417	5/8-11	15/16	41/64	25
NT9419	3/4-10	1-1/8	3/4	20
NT9421	7/8-9	1-5/16	7/8	15
NT9423	1-8	1-1/2	1	10
NT9427	1-1/8-7	1-11/16	1-5/32	EA
NT9429	1-1/4-7	1-7/8	1-17/64	EA
NT9433	1-1/2-6	2-1/4	1-1/2	EA
W.A.F. = With Across Flats				

HIGH ALLOY PFC9 LOCK NUT NF

IBS No.	Tap Size	W.A.F.	Thickness	Qty
4400	1/4-20	7/16	.288	100
4401	5/16-18	1/2	.336	100
4402	3/8-16	9/16	.415	100
4403	7/16-14	11/16	.463	50
4404	1/2-13	3/4	.573	50
4405	9/16-12	7/8	.621	50
4406	5/8-11	15/16	.731	50
4407	3/4-10	1-1/8	.827	50
4408	7/8-9	1-5/16	.922	25
4409	1-8	1-1/2	1.018	25
W.A.F. = With Across Flats				





High-Alloy Lock Nuts

National Fine

HIGH ALLOY L9 STOVER LOCK NUT NF

IBS No.	Tap Size	W.A.F.	Thickness	Qty
NT9453	1/4-28	7/16	1/4	100
NT9455	5/16-24	1/2	19/64	50
NT9457	3/8-24	9/16	3/8	50
NT9459	7/16-20	11/16	7/16	25
NT9463	1/2-20	3/4	1/2	25
NT9465	9/16-18	7/8	9/16	25
NT9467	5/8-18	15/16	41/64	25
NT9469	3/4-16	1-1/8	3/4	20
NT9471	7/8-14	1-5/16	7/8	15
NT9473	1-14	1-1/2	1	10
NT9477	1-1/8-12	1-11/16	1-5/32	EA
NT9479	1-1/4-12	1-7/8	1-17/64	EA
NT9483	1-1/2-12	2-1/4	1-1/2	EA

W.A.F. = With Across Flats

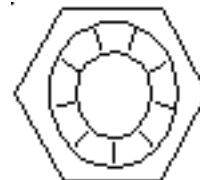

Top View

Nine dashes identify Heat Treated L9 Stover® locknuts. Features registered stover design.

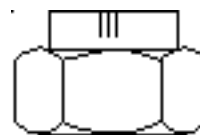

Side View

HIGH ALLOY PFC9 LOCK NUT NF

IBS No.	Tap Size	W.A.F.	Thickness	Qty
6400	1/4-28	7/16	.288	100
6401	5/16-24	1/2	.336	50
6402	3/8-24	9/16	.415	50
6403	7/16-20	11/16	.463	25
6404	1/2-20	3/4	.573	25
6405	9/16-18	7/8	.621	25
6406	5/8-18	15/16	.731	25
6407	3/4-16	1-1/8	.827	20

W.A.F. = With Across Flats



Top View

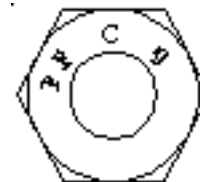

Bottom View

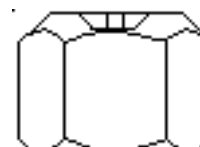

Side View

Features unique trilock design

**H
E
X

N
U
T
S**

THE HIGH-ALLOY FASTENING SYSTEM IS DESIGNED AND MANUFACTURED TO BE USED AS A SYSTEM. NO SUBSTITUTIONS OR ALTERATIONS ARE TO BE MADE OF THE BOLT, NUT, WASHER OR FINISH.



IBS, INCORPORATED

Hex Stover Flange Lock Nuts B05

HEX NUTS

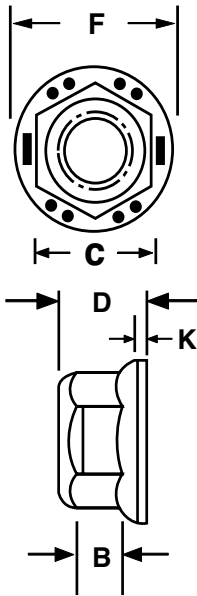

Stover Flange Nuts

Grade G

150,000 psi Tensile Strength



- Furnished with a phosphate and oil finish for lubrication during assembly.
- Enlarged countersink on bearing face to facilitate starting.
- Simplifies assembly by eliminating the need for washers.
- 4 times the bearing area of hex nuts.
- Lower bearing stress for irregular holes.

STOVER FLANGE NUTS

IBS No.	Size	C W.A.F	F Flange Diam	D Overall Thickness	B Hex Height	K Flange Thickness	Qty
4000	3/8-16	9/16	0.810	0.425	0.200	0.060	100
4001	1/2-13	3/4	1.070	0.555	0.260	0.080	50
4002	5/8-11	15/16	1.330	0.690	0.320	0.100	25
4003	3/4-10	1-1/8	1.585	0.750	0.380	0.110	25
4007	1/2-20	3/4	1.070	0.555	0.260	0.080	50
4008	5/8-18	15/16	1.330	0.690	0.320	0.100	25
4009	3/4-16	1-1/8	1.563	0.750	0.594	0.156	20

W.A.F. = Width Across Flats

The Flanged Fastener Advantages

- Greater Bearing Area
- Better Coverage of Irregular Holes
- Elimination of Washers
- Weight and Size Reduction





Grade 8 Finished Hex Nuts

150,000 psi Minimum Tensile Strength

- Exceeds original equipment specifications.
- Made of High Strength Alloy Steel giving them 30% more holding power.
- Eliminates stripping threads, vibration, heat and stress fatigue.
- Plated nuts are Zinc and Yellow Baked.

NATIONAL COARSE

NATIONAL FINE

IBS No.		Size	W.A.F.	Qty	IBS No.		Size	W.A.F.	Qty
Plain	Plated				Plain	Plated			
4010	4610	1/4-20	7/16	100	6021	6640	1/4-28	7/16	100
4011	4611	5/16-18	1/2	100	6022	6641	5/16-24	1/2	100
4012	4612	3/8-16	9/16	100	6023	6642	3/8-24	9/16	100
4013	4613	7/16-14	11/16	100	6024	6643	7/16-20	11/16	100
4014	4614	1/2-13	3/4	100	6025	6644	1/2-20	3/4	100
4015	4615	9/16-12	7/8	50	6026	6645	9/16-18	7/8	25
4016	46165	5/8-11	15/16	50	6027	6646	5/8-18	15/16	50
4017	4617	3/4-10	1-1/8	25	6028	6647	3/4-16	1-1/8	25
4018	4618	7/8-9	1-5/16	25	6029	6648	7/8-14	1-5/16	25
4019	4619	1-8	1-1/2	20	6030	6649	1-14	1-1/2	20
4020	—	1-1/8-7	1-11/16	EA	6031	—	1-1/8-12	1-11/16	EA
4021	—	1-1/4-7	1-7/8	EA	6032	—	1-1/4-12	1-7/8	EA
4023	—	1-1/2-6	2-1/4	EA	—	—	—	—	—

W.A.F. = Width Across Flats

**H
E
X

N
U
T
S**

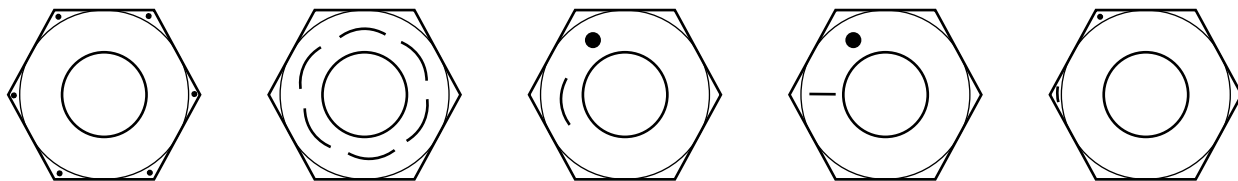

Grade 8 Hex Nut Markings



IBS, INCORPORATED

Grade C Lock Nuts B07

Prevailing Torque Locknuts Grade C



- Strongest locking power available.
- Ideal for applications where shock and vibration is a problem.

This patented, prevailing torque locknut gets its exceptionally high locking ability from the controlled deformation of its upper threads.

This design is unique in that it features a true round shape at the bearing face, which allows for easier starting, and changes to an oval shape at the top.

As the nut is tightened the deformed top threads are deflected, causing them to conform to the shape of the screw. This creates an increased frictional drag and results in increased locking power.

This Spring Action (top threads conforming to the screw shape) distributes the clamping forces over the largest possible surface area. This ensures minimum wear, burnishing, and avoids permanent set. This balanced design is what provides the locknut with its high performance and reusability qualities.

H
E
X

N
U
T
S

PREVAILING TORQUE LOCK NUTS GRADE C - NC			
IBS No.	Size	W.A.F.	Qty
4026	1/4-20	7/16	100
4027	5/16-18	1/2	100
4028	3/8-16	9/16	100
4029	7/16-14	11/16	100
4030	1/2-13	3/4	50
4031	9/16-12	7/8	50
4032	5/8-11	15/16	25
4033	3/4-10	1-1/8	20
4034	7/8-9	1-5/16	15
4035	1-8	1-1/2	10

PREVAILING TORQUE LOCK NUTS GRADE C - NF			
IBS No.	Size	W.A.F.	Qty
6035	1/4-28	7/16	100
6036	5/16-24	1/2	100
6037	3/8-24	9/16	100
6038	7/16-20	11/16	100
6039	1/2-20	3/4	50
6040	9/16-18	7/8	50
6041	5/8-18	15/16	25
6042	3/4-16	1-1/8	20
6043	7/8-14	1-5/16	15
6044	1-14	1-1/2	10





Finished Hex Nuts (B09)

- Specially formulated high quality nut steel manufactured on the most modern close tolerance cold forming equipment.
- Dependability insured by strict quality control.
- Zinc plating protects against rust and corrosion.



FINISHED HEX NUTS NATIONAL COARSE			
IBS No.	Size	W.A.F.	Qty
4050	1/4-20	7/16	100
4051	5/16-18	1/2	100
4052	3/8-16	9/16	100
4053	7/16-14	11/16	100
4054	1/2-13	3/4	100
4055	9/16-12	7/8	50
4056	5/8-11	15/16	50
4057	3/4-10	1-1/8	25
4058	7/8-9	1-5/16	25
4059	1-8	1-1/2	10
4060	1-1/8-7	1-11/16	EA
4061	1-1/4-7	1-7/8	EA
4063	1-1/2-6	2-1/4	EA

FINISHED HEX NUTS NATIONAL FINE			
IBS No.	Size	W.A.F.	Qty
6074	1/4-28	7/16	100
6075	5/16-24	1/2	100
6076	3/8-24	9/16	100
6077	7/16-20	11/16	100
6078	1/2-20	3/4	100
6079	9/16-18	7/8	25
6080	5/8-18	15/16	25
6081	3/4-16	1-1/8	25
6082	7/8-14	1-5/16	25
6083	1-14	1-1/2	10

Grade 5 Hex Nuts (B10)

- **Proof Load** 120,000 psi.
- **Hardness** HRB 86-93.
- **Zinc Plated** to protect against corrosion.
- **Manufactured and Tested** according to AISI Specifications.

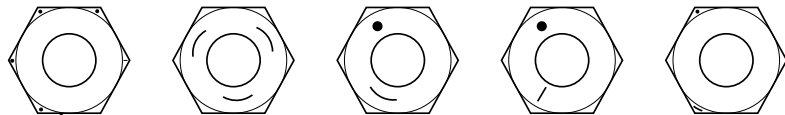

GRADE 5 HEX NUTS - NC			
IBS No.	Size	W.A.F.	Qty
4100	1/4-20	7/16	100
4101	5/16-18	1/2	100
4102	3/8-16	9/16	100
4103	7/16-14	11/16	100
4104	1/2-13	3/4	100
4106	5/8-11	15/16	50
4107	3/4-10	1-1/8	25

GRADE 5 HEX NUTS - NF			
IBS No.	Size	W.A.F.	Qty
4110	1/4-28	7/16	100
4111	5/16-24	1/2	100
4112	3/8-24	9/16	100
4113	7/16-20	11/16	100
4114	1/2-20	3/4	100
4116	5/8-18	15/16	50
4117	3/4-16	1-1/8	25

**H
E
X

N
U
T
S**



IBS, INCORPORATED

Grade 8 Nylon Locknuts B08

Nylon Locknuts Grade 8

The locking collar, which has an inside diameter smaller than the diameter of the bolt, is unthreaded and elastic. This allows the bolt to impress a mating thread into the collar and the resulting compressive forces exert a constant friction grip on the bolt. As downward thrust is exerted the lower flanks of the bolt thread are brought into a firm metal-to-metal contact with the matching threads on the nut thus eliminating axial play which may normally occur. Even after repeated usage the elastic collar still retains its grip.

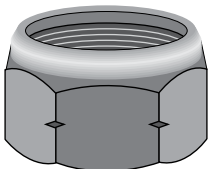
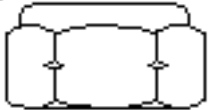

- Locks in any position on the bolt.
- Vibration and shock proof.
- Locking collar will not gall bolt thread.
- Nylon seals out moisture and retards rust and corrosion of the thread area.
- This material is resistant to oil, fats, gasoline, and other destructive chemical agents

H
E
X

N
U
T
S

NYLON LOCKNUTS GRADE 8 NATIONAL COARSE

IBS No.		Dimensions				Qty
Plain (Black)	Zinc Yellow	Tap Size	W.A.F.	Ht.		
4040	4140	1/4-20	7/16	5/16	25	
4041	4141	5/16-18	1/2	11/32	25	
4042	4142	3/8-16	9/16	29/64	25	
4043	4143	7/16-14	5/8	29/64	25	
4044	4144	1/2-13	3/4	19/32	25	
4045	4145	9/16-12	7/8	41/64	10	
4046	4146	5/8-11	15/16	3/4	10	
4047	4147	3/4-10	1-1/16	7/8	10	
4048	4148	7/8-9	1-1/4	63/64	EA	
4049	4149	1-8	1-7/16	1-3/64	EA	

NYLON LOCKNUTS GRADE 8 NATIONAL FINE

IBS No.		Description				Qty
Plain (Black)	Zinc Yellow	Tap Size	W.A.F.	Ht.		
6049	6249	1/4-28	7/16	5/16	25	
6050	6250	5/16-24	1/2	11/32	25	
6051	6251	3/8-24	9/16	29/64	25	
6052	6252	7/16-20	5/8	29/64	25	
6053	6253	1/2-20	3/4	19/32	25	
6054	6254	9/16-18	7/8	41/64	10	
6055	6255	5/8-18	15/16	3/4	10	
6056	6256	3/4-16	1-1/16	7/8	10	
6057	6257	7/8-14	1-1/4	63/64	EA	
6058	6258	1-14	1-7/16	1-3/64	EA	





Nylon Locknuts Zinc Plated

The locking collar, which has an inside diameter smaller than the diameter of the bolt, is unthreaded and elastic. This allows the bolt to impress a mating thread into the collar and the resulting compressive forces exert a constant friction grip on the bolt. As downward thrust is exerted the lower flanks of the bolt thread are brought into a firm metal-to-metal contact with the matching threads on the nut thus eliminating axial play which may normally occur. Even after repeated usage the elastic collar still retains its grip.

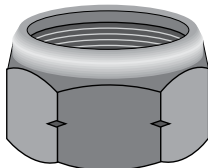
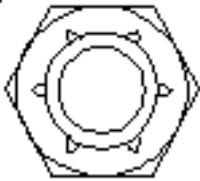

- Locks in any position on the bolt.
- Vibration and shock proof.
- Locking collar will not gall bolt thread or remove plating.
- Nylon seals out moisture and retards rust and corrosion of the thread area.
- This material is resistant to oil, fats, gasoline, and other destructive chemical agents.
- Zinc plated to protect against rust and corrosion.

NYLON LOCKNUTS ZINC PLATED NATIONAL COARSE				
IBS No.	Tap Size	W.A.F.	Ht.	Qty
5000	4-40	1/4	5/32	100
5001	6-32	5/16	11/64	100
5002	8-32	11/32	7/32	100
5003	10-24	3/8	15/64	100
5003A	12-24	7/16	5/16	100
5004	1/4-20	7/16	5/16	100
5005	5/16-18	1/2	11/32	100
5006	3/8-16	9/16	29/64	100
5007	7/16-14	5/8	29/64	100
5008	1/2-13	3/4	19/32	50
5009	9/16-12	7/8	41/64	50
5010	5/8-11	15/16	3/4	25
5011	3/4-10	1-1/16	7/8	25
5012	7/8-9	1-1/4	63/64	25

NYLON LOCKNUTS ZINC PLATED NATIONAL FINE				
IBS No.	Tap Size	W.A.F.	Ht.	Qty
—	—	—	—	—
—	—	—	—	—
—	—	—	—	—
6099	10-32	3/8	15/64	100
—	—	—	—	—
6100	1/4-28	7/16	5/16	100
6101	5/16-24	1/2	11/32	100
6102	3/8-24	9/16	29/64	100
6103	7/16-20	5/8	29/64	100
6104	1/2-20	3/4	19/32	50
6105	9/16-18	7/8	41/64	50
6106	5/8-18	15/16	3/4	25
6107	3/4-16	1-1/16	7/8	25
6108	7/8-14	1-1/4	63/64	25

H
E
X

N
U
T
S



IBS, INCORPORATED

Machine Screw Nuts B14 / Misc. Nuts B35

Machine Screw Nuts

Meets or exceeds American Standard B18.6.3
Zinc plated for corrosion resistance



MACHINE SCREW NUTS				
IBS No.	Tap Size	W.A.F.	Thickness	Pkg Qty
5032	4-40	1/4	3/32	200
5033	6-32	5/16	7/64	200
5034	8-32	11/32	1/8	200
5035	10-24	3/8	1/8	200
5036	10-32	3/8	1/8	200
5037	12-24	7/16	5/32	200
5038	1/4-20	7/16	3/16	100
5039	5/16-18	1/2	7/32	100

H
E
X

N
U
T
S



Kep Nuts

KEP NUTS		
IBS No.	Tap Size	Pkg Qty
5056	6-32	100
5057	8-32	100
5058	10-24	100
5059	10-32	100
5060	1/4-20	100
5061	5/16-18	100
5062	3/8-16	100

- Combination standard hex nuts and standard lockwasher.
- Eliminates putting separate lockwasher in position.
- Lockwasher spins free under tension, preventing surface marring or galling.

Whiz Lock Nuts

- Serrated flange provides locking action

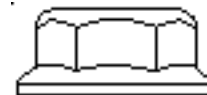
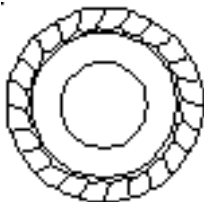

WHIZ LOCK NUTS			
IBS No.	Tap Size	Flange O.D.	Pkg Qty
5066	10-24		100
5068	1/4-20	19/32	100
5069	5/16-18	43/64	100
5070	3/8-16	3/4	100





Hex Jam Nuts



- Jam nuts are thin nuts used under full-sized nuts to develop locking action.
- Zinc plated to protect against rust and corrosion.

HEX JAM NUTS - NATIONAL COARSE				
IBS No.	Tap Size	W.A.F.	Thickness	Qty
4085	1/4-20	7/16	5/32	100
4086	5/16-18	1/2	3/16	100
4087	3/8-16	9/16	7/32	100
4088	7/16-14	11/16	1/4	50
4089	1/2-13	3/4	5/16	50
4090	5/8-11	15/16	3/8	25
4091	3/4-10	1-1/8	27/64	25

HEX JAM NUTS - NATIONAL FINE				
IBS No.	Tap Size	W.A.F.	Thickness	Qty
6085	1/4-28	7/16	5/32	100
6086	5/16-24	1/2	3/16	100
6087	3/8-24	9/16	7/32	100
6088	7/16-20	11/16	1/4	50
6089	1/2-20	3/4	5/16	50
6091	5/8-18	15/16	3/8	25
6092	3/4-16	1-1/8	27/64	25



Nyloc Jam Nuts

- Thin jam nuts with nylon locking rings
- Lock in any position on bolt
- Zinc plated to prevent rust and corrosion

NYLOC JAM NUTS NATIONAL COARSE		
IBS No.	Tap Size	Qty
5020	1/4-20	100
5021	5/16-18	100
5022	3/8-16	100
5024	1/2-13	50
5026	5/8-11	50
5027	3/4-10	25

NYLOC JAM NUTS NATIONAL FINE		
IBS No.	Tap Size	Qty
6114	1/4-28	100
6115	5/16-24	100
6116	3/8-16	100
6118	1/2-20	50
6120	5/8-18	50
6121	3/4-16	25

H
E
X

N
U
T
S



**H
E
X

N
U
T
S**

Heavy Hex Nuts

- Heavier and wider to provide greater bearing area.
- Ideal for heavy duty applications with severe stress and vibration.
- Excellent for oversize holes and certain boiler applications.
- Conforms to all industry standards

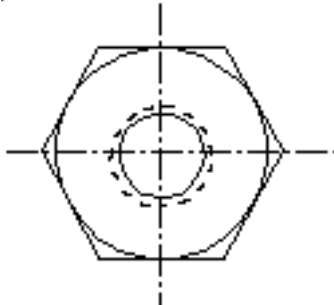

Heavy Hex Nut

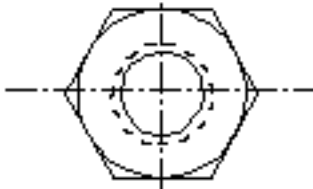

Ordinary Hex Nut

HEAVY HEX NUTS

IBS No.	Tap Size	W.A.F.	Height	Pkg Qty
4070	1/4-20	1/2	13/64	100
4071	5/16-18	9/16	19/64	100
4072	3/8-16	11/16	23/64	100
4073	7/16-14	3/4	27/64	50
4074	1/2-13	7/8	31/64	50
4076	5/8-11	1-1/16	39/64	25
4077	3/4-10	1-1/4	47/64	25
4078	7/8-9	1-7/16	55/64	25
4079	1-8	1-5/8	63/64	25

Coupling Nuts

- Zinc plated to protect against rust and corrosion



COUPLING NUTS

IBS No.	Tap Size	Length	W.A.F.	Pkg Qty
6011 *	1/4-20	7/8	3/8	50
6012 *	5/16-18	7/8	7/16	50
6013 *	3/8-16	1-1/8	1/2	50
6014 *	1/2-13	1-1/4	5/8	50
6015	3/8-11	2-1/8	13/16	20
6016	3/4-10	2-1/4	3/4	20

* Economy - shorter in length than standard units



High Nuts Grade 8

150,000 psi min. tensile strength

- Special design gives added strength.
- 40% More thread engagement.
- 40% Higher than ordinary nuts.

HIGH NUTS Grade 8

IBS No.	Tap Size	W.A.F.	Height	Pkg Qty
6063	7/16-20	5/8	17/32	50
6064	1/2-20	3/4	11/16	50
6066	5/8-16	15/16	27/32	25
6067	3/4-16	1-1/16	1	25
6068	7/8-14	1-1/4	1-5/32	10
6069	1-14	1-7/16	1-5/16	10



Cap Nuts

CAP NUTS

IBS No.	Tap Size	Pkg Qty
5075	6-32	100
5076	8-32	100
5077	10-24	100
5079	1/4-20	100
5080	5/16-18	100
5081	3/8-16	50



Wing Nut - Nyloc

IBS No. 5095 $\frac{3}{8}$ -16



Package Quantity = 25

- Zinc Plated to protect against rust and corrosion.
- Nylon locking ring locks in any position on bolt.
- Locking collar will not gall bolt thread or remove plating.
- Vibration and shock proof.

**H
E
X

N
U
T
S**



IBS, INCORPORATED

Miscellaneous Nuts B35

H
E
X

N
U
T
S

Wing Nuts



- Cold forged steel.
- Zinc plated for protection from rust and corrosion.
- Ideal for applications where quick "hand" assembly is desired or needed, i.e.:
 - Light or precision machinery: eliminates the chance of over-tightening, causing thread stripping or parts damage.
 - Power Tools: circular saw blade angle adjustment.
 - Carburetor Air Filter Hold Down Nut and more!

WING NUTS

IBS No.	Tap Size	Pkg Qty
5086	8-32	100
5087	10-24	100
5088	10-32	100
5089	1/4-20	100
5090	5/16-18	100
5091	3/8-16	100
5092	1/2-13	50

"Tee" Nuts

3 Prong - Wood Type



- Pronged nut stays where it's put.
- Zinc plated for protection from rust and corrosion.
- Great for picnic tables and wooden lawn furniture.

TEE NUTS

IBS No.	Tap Size	Barrel	Flange	Pkg Qty
6000	6-32	1/4	9/16	100
6001	8-32	1/4	3/4	100
6002	10-24	5/16	23/32	100
6004	1/4-20	7/16	25/32	100
6006	3/8-16	7/16	1-1/16	100

